

- 1 Attach base plates to posts, using supplied bolts and allen tool. Make sure SEG grooves with special notches of the uprights are facing toward front.

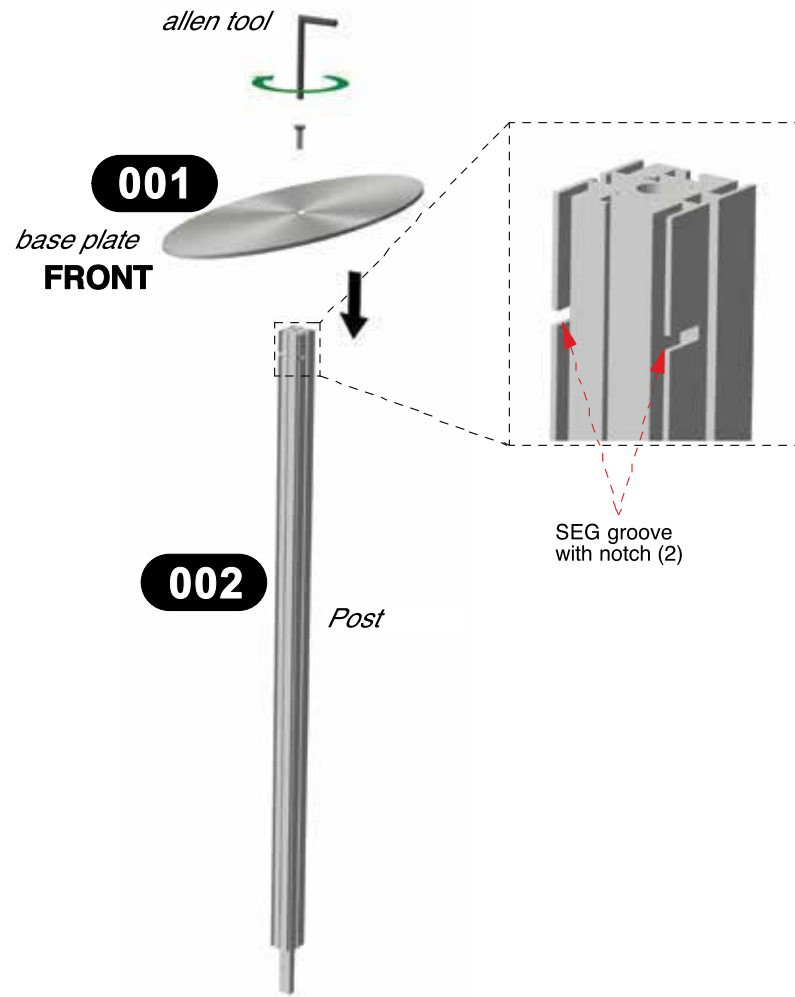

- 2 Slide upper post onto connector of bottom post. Before sliding upper post onto connector make sure T25 screw on splice is tighten and it is not on the way of internal channel of the post. Once the post is placed tighten T25 screw on connector counterclockwise using supplied Torx tool. Repeat procedures for second post assembly.

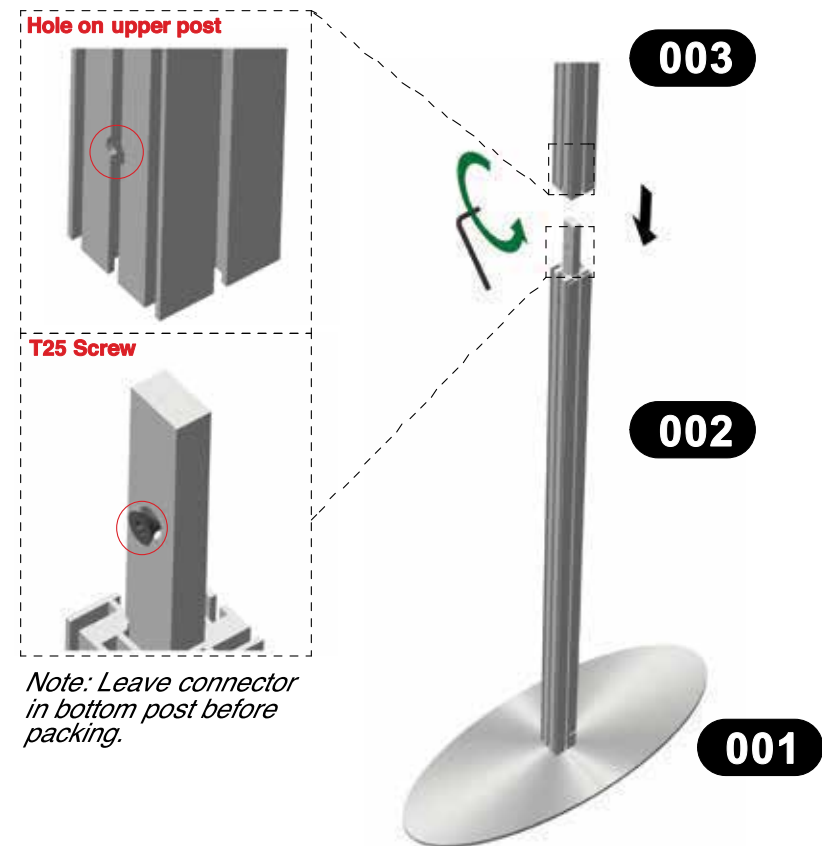

3

Connect horizontal extrusions together as it was discribed in step 1.

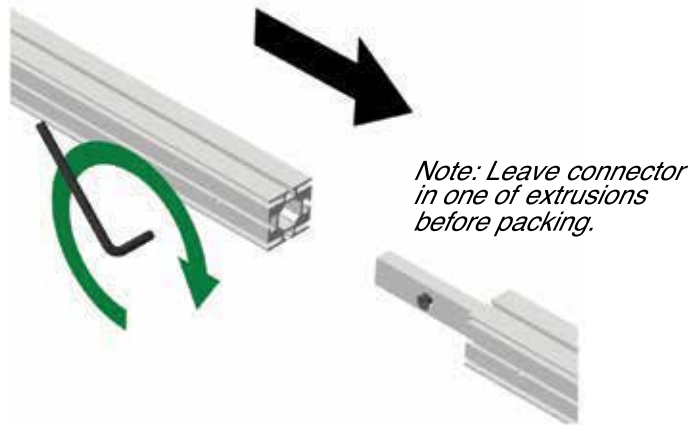

*upper horizontal connected extrusions*

006

007

*lower horizontal connected extrusions*

004

005

4

Attach top and bottom horizontal extrusions to posts as shown. Secure locks using torx tool. Be sure

- All connector holes are facing back
- SEG fabric grooves with notches on posts #002 and #003 are facing front

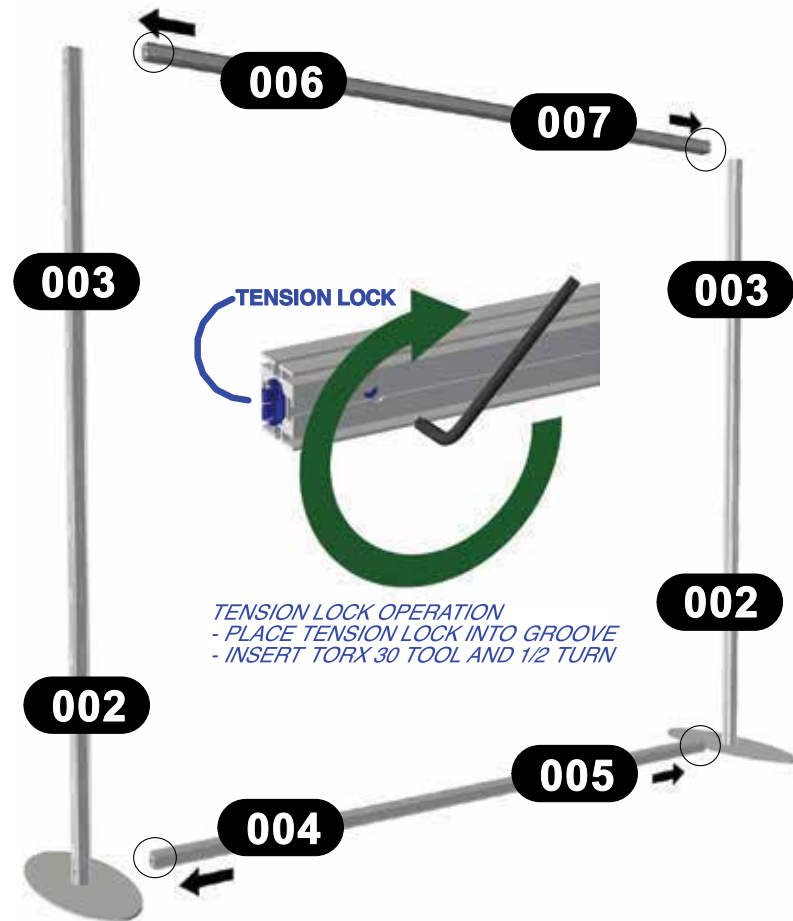

**5**

Connect panel grippers (8 total) to posts (nylon set screw facing back) and tighten using supplied screw driver.

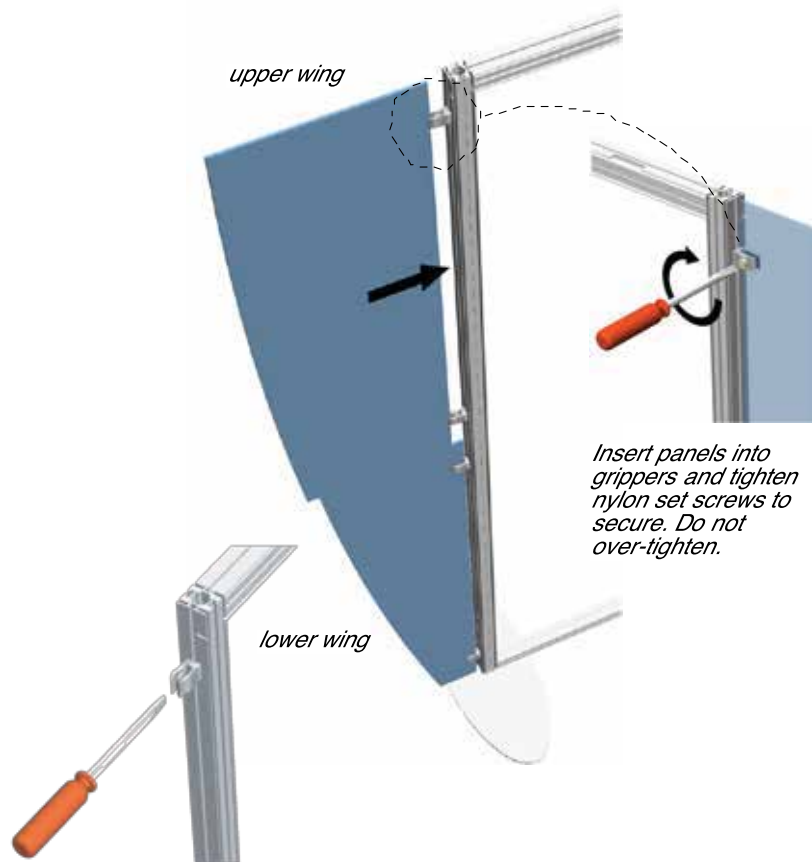

**6**

Connect 4 panel grippers to upper vertical extrusion (nylon set screw facing back) and tighten. Insert header into grippers and tighten nylon set screws to secure. Do not over-tighten.

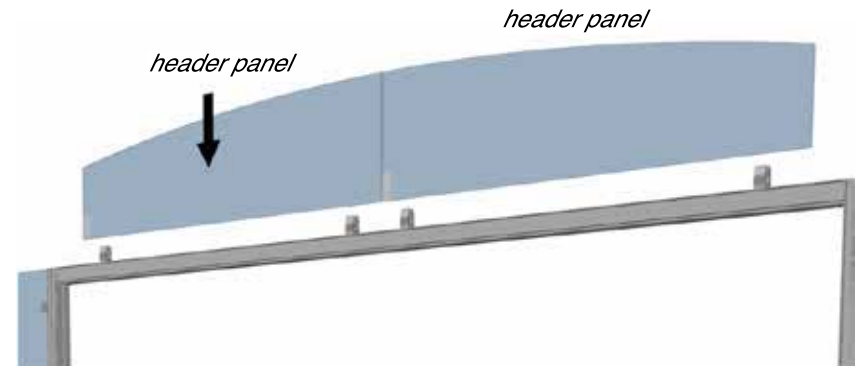

### Light Attachment (optional)

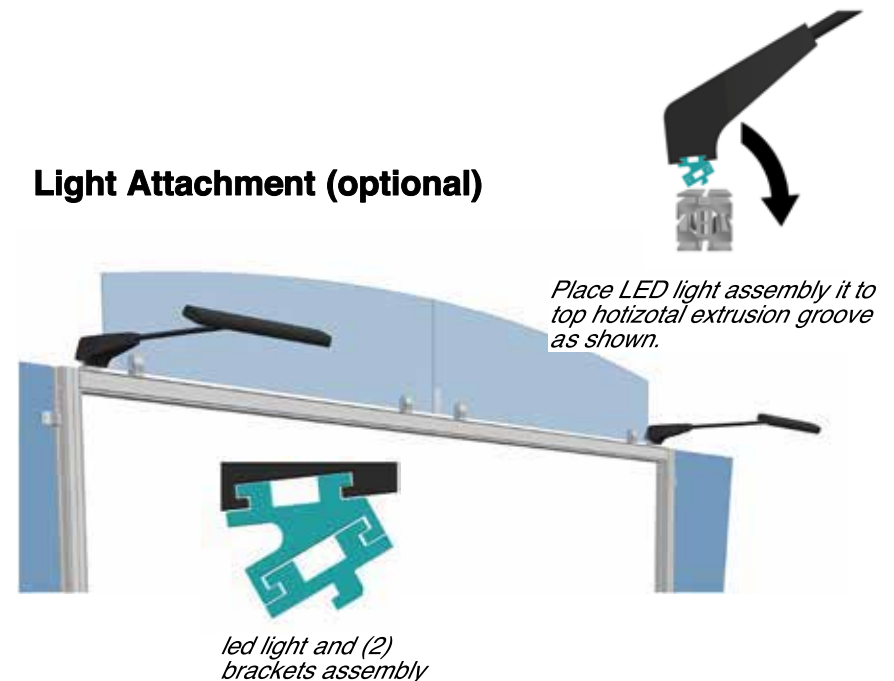

**7**

Connect sections of canopy as shown. Be sure push buttons click into position. Use allen wrench to tighten left and right posts of canopy. Be sure screws on posts facing back. Stretch fabric over frame so zipper is in rear.

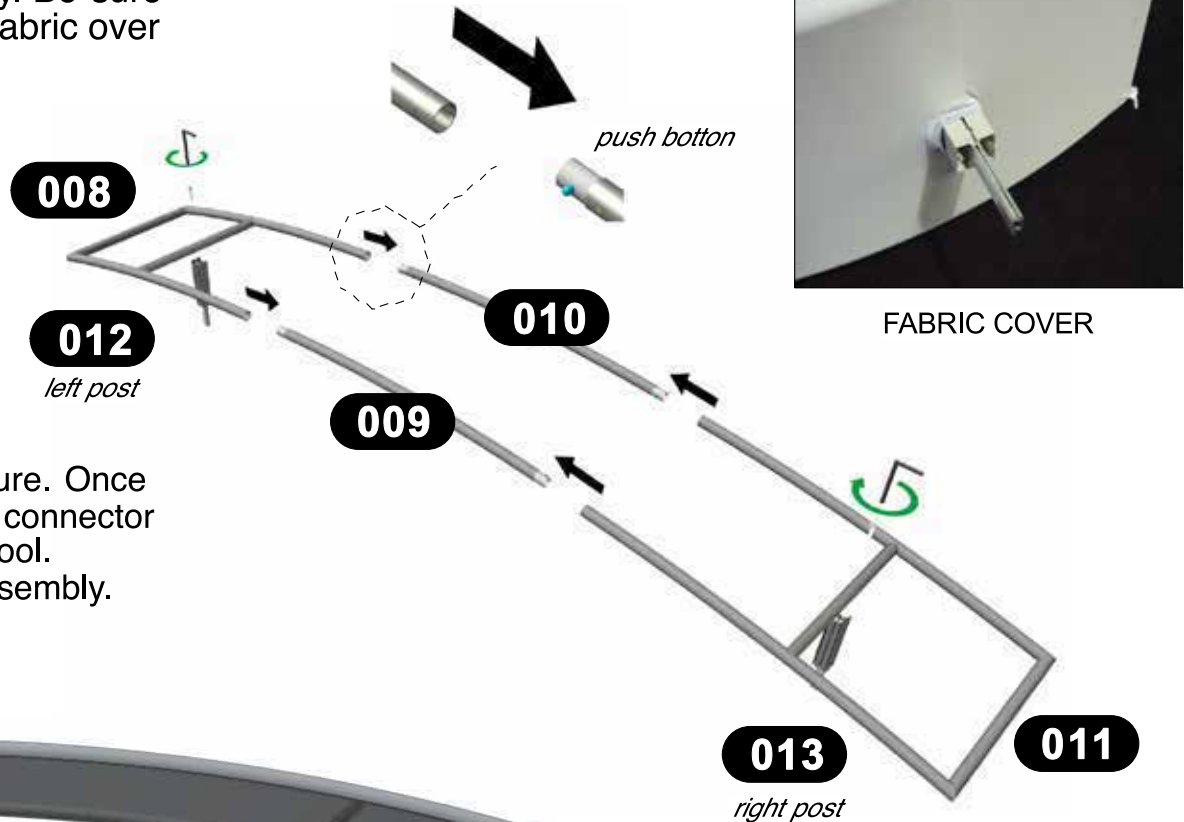

Place canopy on top of backwall structure. Once posts are placed tighten T25 screw on connector counterclockwise using supplied Torx tool. Repeat procedures for second post assembly.



8

**FABRIC ATTACHMENT:**

Start with corners by squeezing silicon edge of fabric into SEG groove. Then repeat procedure for center areas and work your way to corner from center in both directions.

**Removal:**

Use pull tab on bottom corner to pull fabric out from extrusion groove.

**NOTE:**

Always use gloves when working with fabric.

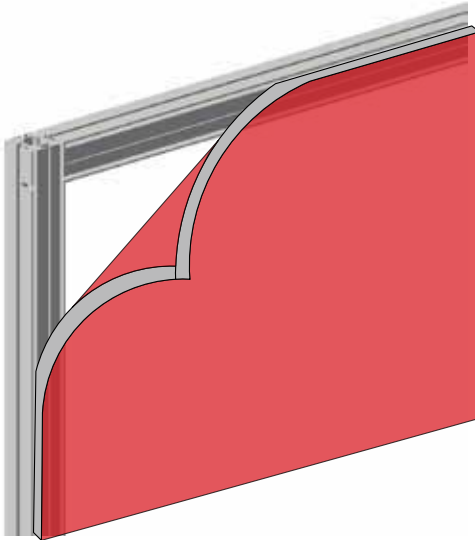

- 9 1. Lock #014 counter top support bracket to backwall post at marked position.
2. Attach counter top #016 to V-shape counter base #015 with provided (2) thumbscrews.
3. Place assembled top with V-shape base against backwall, align holes on #014 support bracket with inserts under #016 counter top and secure top to bracket with provided (2) socket head screws.

Optional:

Repeat procedures for second counter if exists.

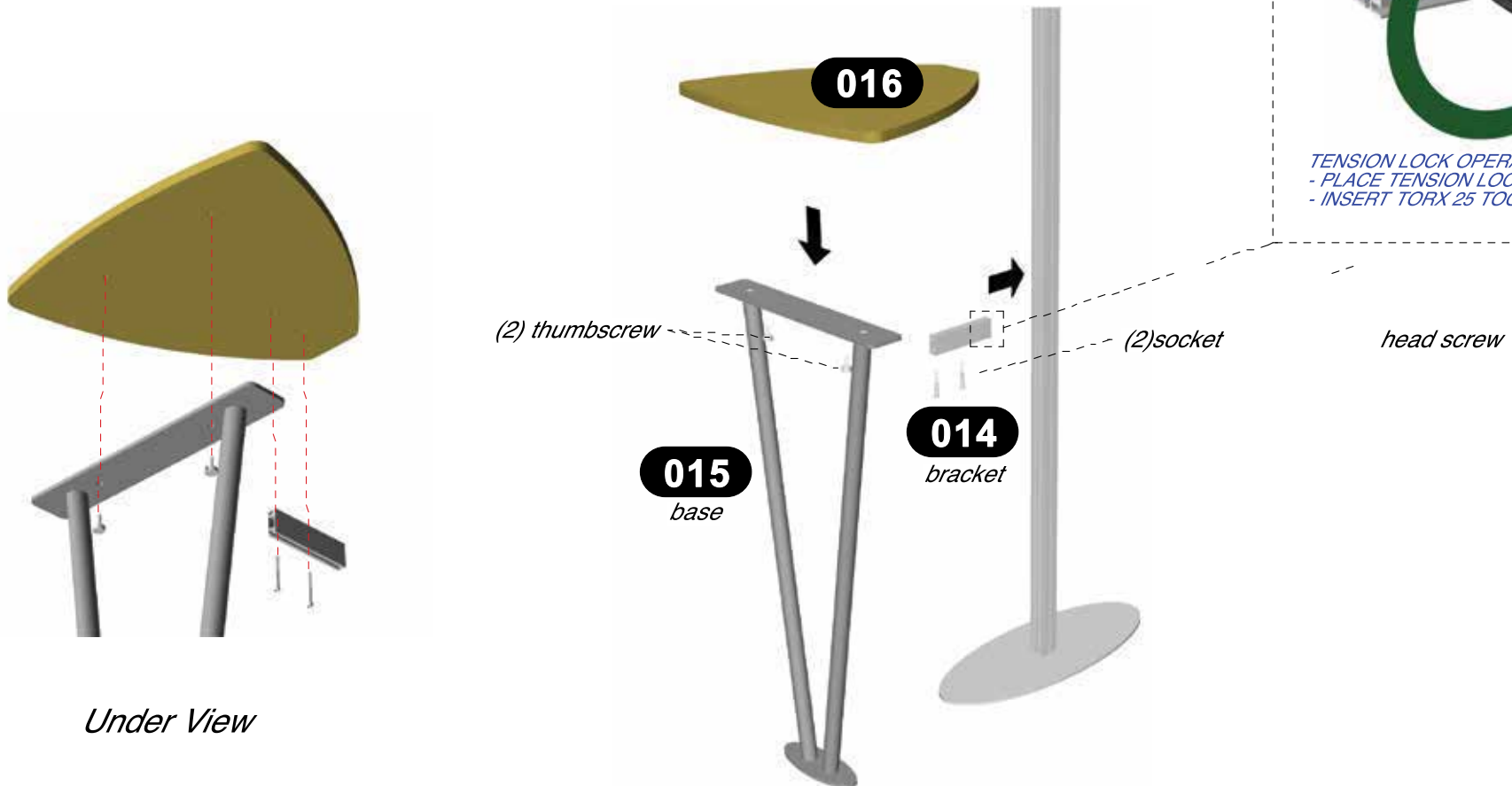

10

1. Detach removable plate (if received attached) from connection bracket and place each part into groove of post separate. Align holes on each part and tighten with provided screws.
2. Secure TV Mount Back Bracket to connection bracket with provided screws.
3. Attach TV Mount Front Bracket (if received detach) to back of TV. Hang TV on Back Bracket assembly and if required adjust tilt angle of TV with side bolts and secure it in position.

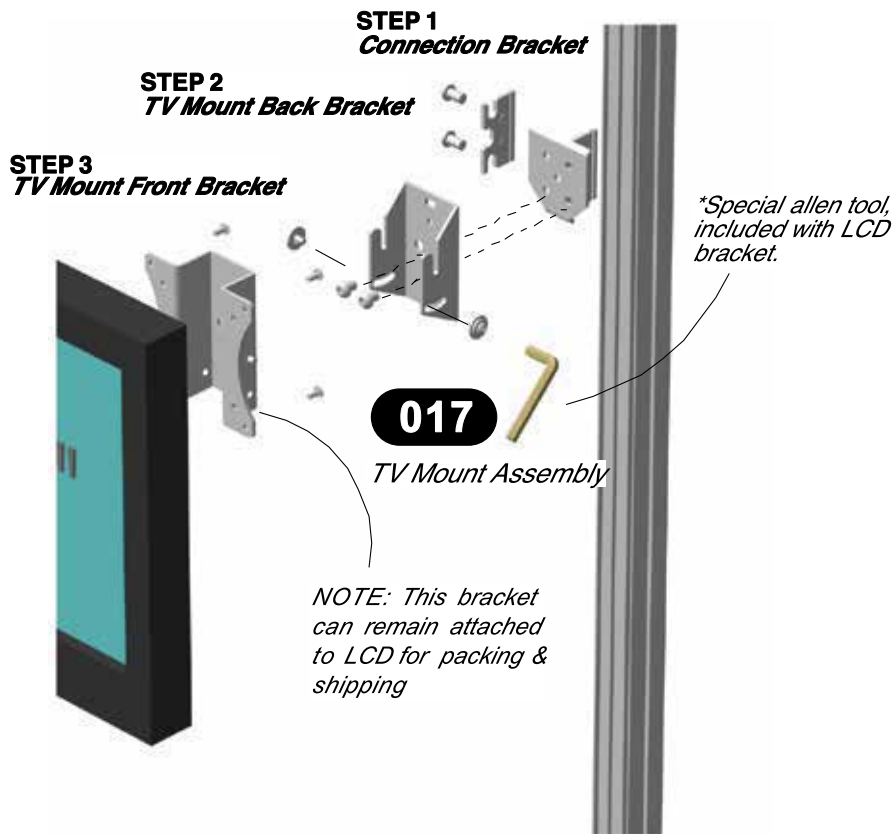

1. Lock #018 shelf support bracket to backwall post.
2. Attach shelf to support bracket with provided (2) socket head screw.

Optional:  
Repeat procedures for other shelves if exist.

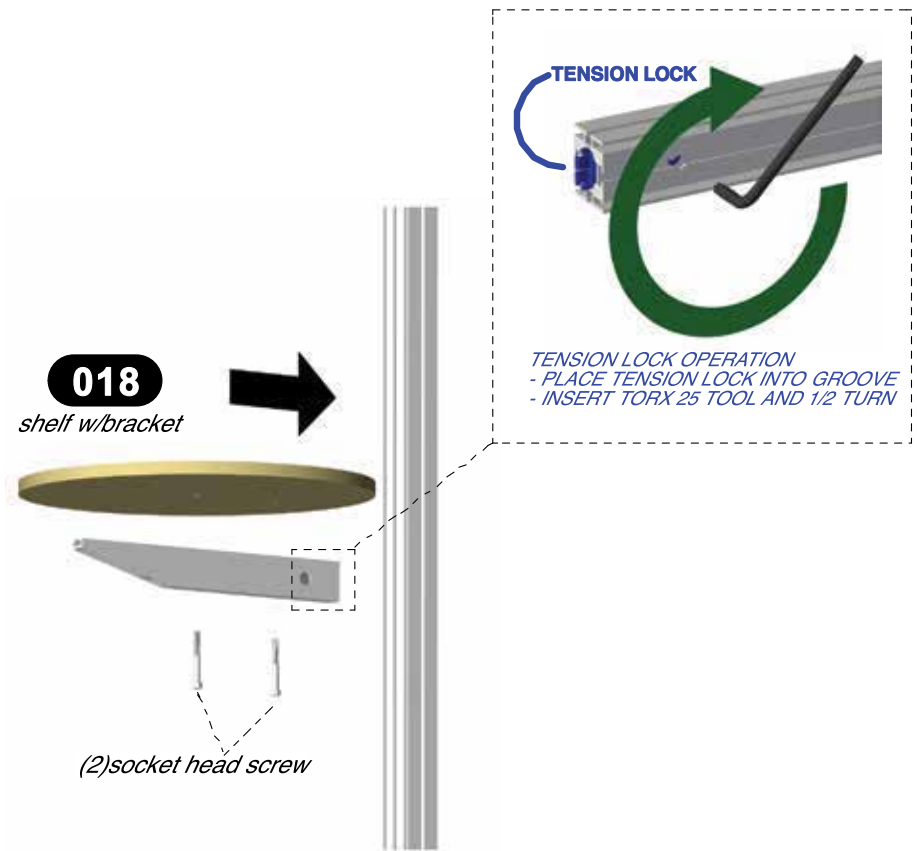



11

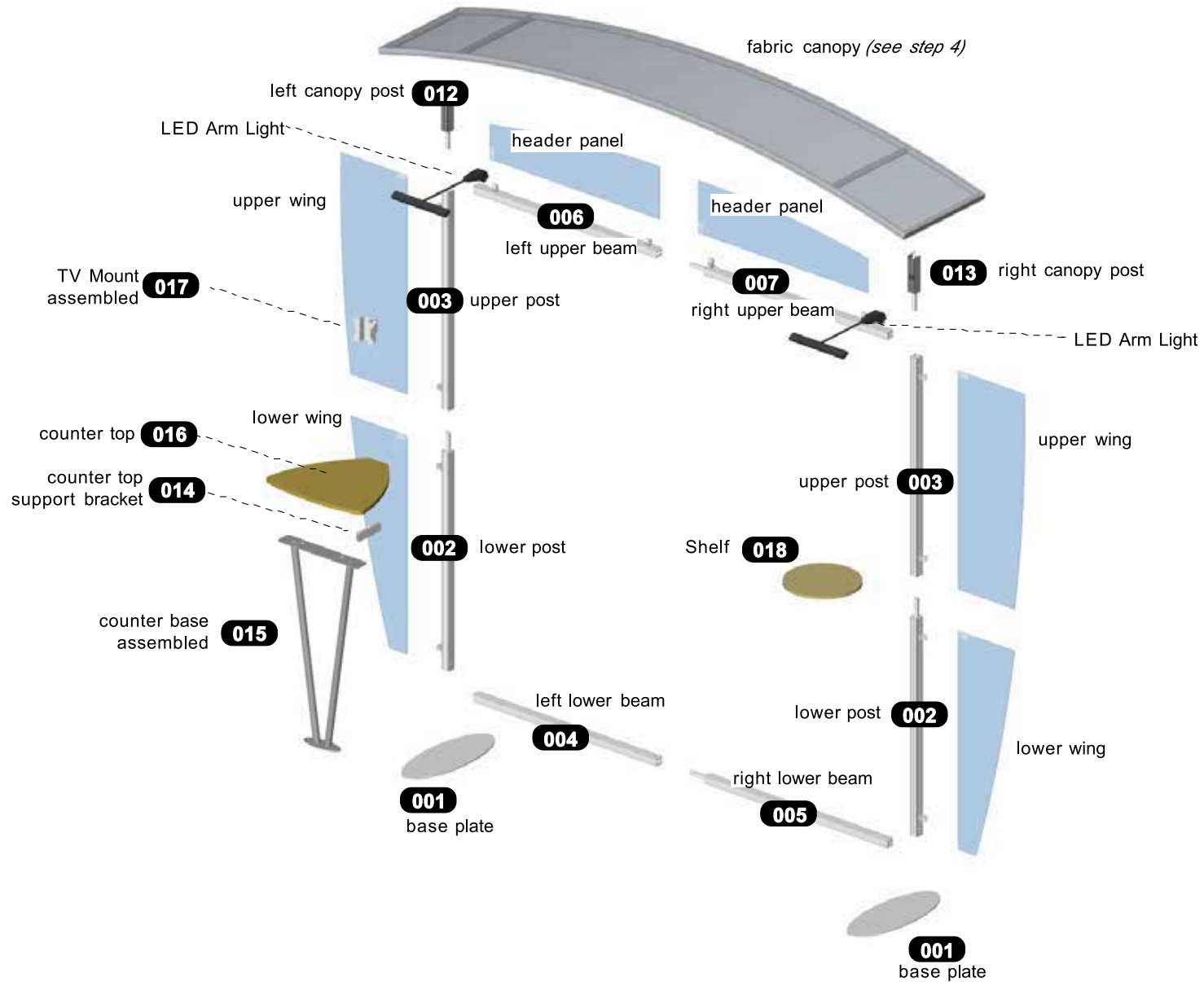



12

**MAIN UNIT  
CASE**

**TV OPTION  
CASE**

**SIXTH LAYER:**

Setup Instruction

**FIFTH LAYER:**

Bag with Canopy Fabric

**FOURTH LAYER:**

Fabric Canopy Tube

008

Fabric Canopy Tube

009

Counter Base Assembled

015

**THIRD LAYER:**

upper wing (2)

lower wing (2)

header panel

**SECOND LAYER:**

Optional : LED Arm Light

right upper beam

007

left upper beam

006

right lower beam

005

left lower beam

004

upper post (2)

003

lower post (2)

002

**FIRST LAYER:**

Optional: Shelf (2)

018

counter top

016

base plate (2)

001

**PADDED BAG:**

Grippers, Bolts, Tools

Canopy posts, Counters ar

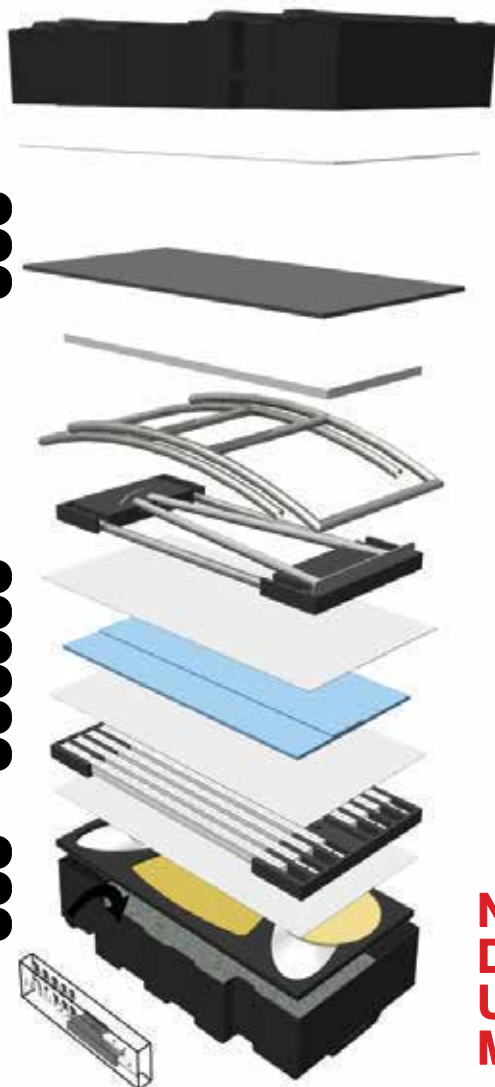

**NOTE:**  
**DO NOT DISCARD ANY PACKING MATERIALS.**  
**USE ALL PACKING MATERIALS IN SAME**  
**MANNER AS THEY WERE RECEIVED.**